

Applying for English-language education for the 7th Grade

School year 2024-2025

Espoo International School

About arranging basic education

- Espoo, like other municipalities, has an obligation to arrange basic education for children of compulsory school age residing in its area. Pupils have **a subjective right to attend a local school** (primary school) assigned by the municipality. Basic education is given in Finnish.
- Pupils who cannot yet speak Finnish or whose Finnish language skills are not equivalent to those of a native speaker have the opportunity to be supported in increasing their Finnish language skills and to participate in **preparatory education**.
- Pupils can also apply for a place in English-language education. Pupils, however, **do not have a subjective right to be admitted to English-language education**, as opposed to applying to a local school.



English-language education in Espoo

- Intended for pupils in basic education **who live in Espoo.**
- **Nearly all the teaching is in English.** The aim is to give the pupils the kind of linguistic skills that enable them to continue their studies in both English and Finnish even after basic education.
- **Follows the national Finnish curriculum in all subjects.**
 - The A1 language is English and the A2 language either French or Spanish.
 - Finnish is studied either as mother's tongue or according to the Finnish as a Second Language curriculum.
- Pupils are admitted for English-language education in accordance with **the Principles of pupil admission for English-language education** decided by the Growth and Learning Committee.



The differences between English-language education and Bilingual (Finnish-English) education

English-language Education	Bilingual Education (Finnish-English)
Finnish National Core Curriculum for Basic Education	
Allocation of lesson hours, slight differences FIN vs. ENG	
English as medium of instruction for all subjects	More subjects taught in Finnish in higher grades
International School	Stream within a Finnish School

Study places for the school year 2024-2025

7th Grade

- Pupils attending English-language education in the 6th Grade at Espoo International School transfer to the 7th Grade automatically. If there are still places available after these pupils, new applicants will be admitted based on an entrance examination.
- A maximum of **100 applicants** meeting the principles of pupil admission (including pupils who continue studying in English-language education in the 7th grade).

How to apply

Enrolling in the 7th grade and applying for English-language Education

- Enrolling in the 7th grade and applying for English-language education takes place through the electronic Wilma service <https://espoo.inschool.fi/> **between 9th and 16th January, 2024** by filling in the form 'Application for 7th grade of comprehensive school'.
- **If your child is studying at the Espoo International School in the 6th grade**, he/she is not required to apply for English-language education in 7th grade if he/she is continueing studying in English-language education.
- **Before applying** for English-language education, familiarize yourself with the instructions and the principles of pupil admission at espoo.fi/en/schooladmissions
> Weighted-curriculum education > English-language education.

[Front page](#) / [Childcare and education](#) / [Basic education](#) / [School admissions](#) / [Weighted-curriculum education](#) / [English-language education](#)









English-language education

Beginning from the first grade, the pupil has an opportunity to apply for English-language education. English-language education is arranged in Espoo International School and Kivimies International School. On this page, you can find instructions for applying.

English-language education is meant for pupils living in Espoo and Kauniainen. Pupils who have moved abroad and are temporarily living in Espoo, can apply for a temporary study places.

The basis for admission is either a pass grade in the entrance examination or previous studies in English-language education. Applicants admitted to English-language education are not entitled to school transport subsidy. The applicant's younger sister or brother does not have a sibling basis to be admitted in the same school.

Before you fill in the application form, familiarize yourself with the instructions and the principles of pupil admission down below.

Applying for grades 1-9 during school year 2023-2024	
Applying for 1st grade (school year 2024-2025)	
Applying for 7th grade (school year 2024-2025)	
Applying for grades 2-6 tai 8-9 (school year 2024-2025)	
Applying for a temporary study place	
Schools providing English-language education	
Principles of pupil admission	
Frequently asked questions (FAQ)	

Filling in the form in Wilma

Log in to your personal Wilma account at <https://espoo.inschool.fi/>.

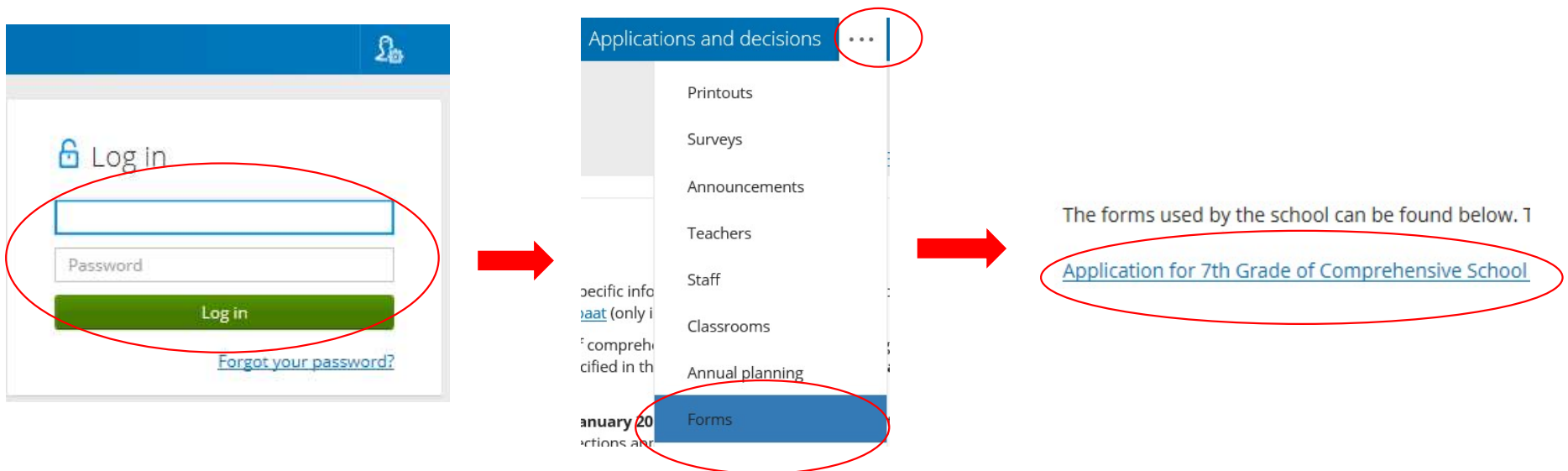

Filling in the form in Wilma

4. APPLYING FOR WEIGHTED-CURRICULUM EDUCATION

☐ The pupil is applying for Weighted-curriculum education, English-language education, Bilingual education (Finnish-English) or Swedish-language immersion education.

Indicate the **application order** below with the number 1–4 (1 = first preference, 2 = second preference, etc.). It is possible to apply for up to four schools/forms of education. The indicated application order is binding! **Check** the entrance examination dates and additional instructions at [espoo.fi/en/schooladmissions](https://www.espoo.fi/en/schooladmissions) (<https://www.espoo.fi/en/childcare-and-education/school-admissions>) > Weighted-curriculum education.

4.1 Application preferences

You can open the whole list by clicking the button at the end of the field.

1st preference:

2nd preference:

3rd preference:

4th preference:

1) **Inform** in the section 4 of the form that your child is applying for weighted-curriculum education or foreign language education.

2) **Indicate** in the section 4.1. of the form English-language education as a application preference.

Unable to use Wilma?

Enrolling in the 7th Grade of comprehensive school takes place between 9th and 16th January, 2024.

Familiarize yourself with the instructions and principles of pupil admission at espoo.fi/en/schooladmissions before filling in this form. If your child is studying in a joint comprehensive school in the 6th grade and he/she continues to study in that school in the 7th grade, do not fill in this form.

Submit this form to your child's current school in Espoo by 16 January, 2024 at the latest. If your child is attending a school in another municipality, submit this form to the following address: Finnish Basic Education Unit, assistant Katri Pietarinen, P.O. Box 31, FI-02070 CITY OF ESPOO. Ensure that separate applications or statements are submitted by deadlines specified in this application form and at espoo.fi/en/schooladmissions.

1 PUPIL'S BASIC INFORMATION	Last name	First names	Personal identity code
	Home address		Postal code and city/town
	Current school		
2 GUARDIANS' INFORMATION	Last name	First names	Telephone (in daytime)
	Home address (if not shared with the child)		Postal code and city/town
4 APPLYING FOR WEIGHTED- CURRICULUM EDUCATION (Basic education Act, Section 28)	<p>A pupil can apply for Weighted-curriculum education, English-language education, Bilingual education (Finnish-English) and Swedish-language immersion education. If a pupil applies for these forms of education, a local school is assigned only if the pupil is not admitted to the education he/she applies. It is advised to fill in section 3 of this form for this purpose.</p> <p>Pupils admitted to Weighted-curriculum education, English-language education, Bilingual education (Finnish-English) and Swedish-language immersion education are not entitled to school transport subsidy, and the younger sisters/brothers of the pupil are not entitled to be admitted to the same school when enrolling to a local school. If a pupil is admitted to a school where he/she is unable to study the A2-language started in the primary school, the A2-language in question ends.</p>		
	<p>Entrance examination dates and additional information, see espoo.fi/en/schooladmissions > Weighted curriculum education.</p> <p>4.1. Application preferences</p> <p>Indicate the application preferences in order with the number 1–4 (1 = first preference, 2 = second preference, etc.). It is possible to apply for up to four schools or forms education. The indicated order is binding! Check the entrance examination dates and additional instructions at espoo.fi/en/schooladmissions > Weighted curriculum education.</p> <p>English-language education <input type="checkbox"/> Espoo International School</p> <p>Bilingual education (Finnish-English) <input type="checkbox"/> Haukilahhti <input type="checkbox"/> Kilonpuisto <input type="checkbox"/> Kultinmäki <input type="checkbox"/> Nöykkiö </p>		

- **Fill in the paper form 'Application for 7th grade of comprehensive school' at espoo.fi/en/education-forms.**
- **Submit the form to your child's current school in Espoo by 16 January, 2024 at the latest.** If your child resides in another municipality, submit the form to the following address:
The Finnish Basic Education Unit
Assistant Katri Pietarinen
P.O. Box 31
FI-02070 City of Espoo
or
by email to katri.pietarinen@espoo.fi.
- **Applications submitted after the application period are rejected and the applicants will not be given a right to participate in the entrance examination.**

The entrance examination

- The entrance examination will be arranged **on 24 January, 2024 at 9 am at the Espoo International School** (address: Lillhemntintie 1).
- Your child will not receive a separate (personal) invitation to the examination. All applicants must **arrive at the school by 8:45 am.**
- **If your child is ill on the examination date** and is unable to take the entrance examination, another entrance examination can be organised for him/her. You are required to **present a statement** on the illness to the principal of the Espoo International School **before** the examination starts or as soon as you receive it.
- **NOTE!** 6th grade pupils of the Espoo International School are **not required to take part in the entrance examination** as they transfer to the 7th grade automatically.





Moving to Espoo before school year 2024-2025



- Fill in the form 'Application for 7th grade of comprehensive school' and **submit** the form **by 16 January, 2024 at the latest** to the following address:
The Finnish Basic Education Unit
Assistant Katri Pietarinen
P.O. Box 31, FI-02070 City of Espoo
or
by email to katri.pietarinen@espoo.fi.
- Your child must take part in the entrance examination **on 24 January, 2024** at the same time as Espoo residents.
- Your child can only be admitted under a conditional decision, which will enter into force only if he/she moves to Espoo **on 1 August, 2024 at the latest**. The address given in the form must be registered and available in [the Digital and Population Data Services Agency](#) on that day at the latest.

Pupil admission

Admitting applicants to 7th Grade

- If there are places available after pupils who have been admitted to English-language education and are continuing to the seventh grade have been admitted, **new applicants will be admitted based on an entrance examination.**
- In order to be admitted to English-language education, **an applicant must achieve the minimum total score of the entrance examination.**
- **Applicants are admitted in the order of their total score** (0–100 points). If two or more applicants have the same total score, their order will be determined by drawing lots.

Principles of pupil admission are available at espoo.fi/en/schooladmissions
> Weighted-curriculum education > English-language education.

Decisions and delivery

Decisions and delivery

- **You can choose** the means of delivery for the decision when filling in the form Application for 7th grade of comprehensive school. It is possible to choose **only one**.
- Available options
 - 1) The decision will be **published in Wilma on 10 April, 2024**. The decision will not be delivered by post.
 - 2) The decision will be **mailed on 10 April, 2024**. The decision will not be published in Wilma.



After decisions are made

If your child is admitted to English-language education



- **The place will not have to be accepted separately.** The decision will continue in force for the duration of the grades taught in the school.
- Your child is **not entitled** to the school transport subsidy and his/her younger sisters/brothers have **no right** to admission to the same school under the sibling principle.
- **Notify** the principal of the Espoo International School **if your child** moves away or gives up the school place and requests assignment to a local school.

If your child is not admitted to English-language education

- Your child will be **assigned to a local school on 10 April, 2024**. If your child has little or no knowledge of the Finnish language he/she will be **assigned to preparatory education**.
- Your child can **apply for a place in a secondary school** by submitting a form Toissijaiseen kouluun hakeminen (only in Finnish) **by 30 April, 2024 at the latest**.
- You can **appeal the principal's decision** by submitting a written demand for rectification to [the Regional State Administrative Agency of Southern Finland](#). The decision is accompanied by detailed instructions.

Tips for the guardians

- **Fill in the application form in good time**, as Wilma will be busy towards the end of the application period. The form is not available after application period ends.
- If you fill in the paper form, **ensure** that it will arrive by the given deadline. Applications arriving after the given deadline will be disregarded and will not give the right to participate in the entrance examination.
- **Familiarize yourself** with the instructions and the principles of pupil admission at espoo.fi/en/schooladmissions
 - > Weighted-curriculum education
 - > English-language Education.

- **Find out** beforehand where the Espoo International School is located and how to get there.
- **A local school is assigned to your child only if** he/she is not admitted to English-language education (or other weighted-curriculum education) he/she applies.
- **Ask** if anything related to the application or pupil selection is unclear and/or you need further information.

